

LOS ANGELES COUNTY
DEPARTMENT OF PUBLIC WORKS
BENCH MARKS



POMONA QUAD

1990 ADJUSTMENT

**NGVD 29 DATUM
FEET**

PREFACE 1990

The Department of Public Works level net is composed of more than 1,700 miles of levels supporting in excess of 9,000 bench marks. In 1990, a major readjustment of the Baseline and nets was undertaken. To emphasize the complete break with previous elevations, the CY, CG & CL series bench marks have been relabeled DY, DG, & DL, respectively.

To facilitate the adjustment, indexing, and distribution of adjusted values of the net, the County territory is divided into 33 quads or areas. For identification purposes each quad is given a name, viz., "Rosemead," "La Mirada," "Santa Fe", etc. When bench marks and elevations in these nets are used, the name of the quad and the date of the adjustment must be included in the bench mark description, e.g.,

DY 9701 - RDBM TAG IN CB 5FT S/O BCR @ SE COR BOLSA ST & DOMINGUEZ ST
63FT S & 20FT E/O C/L INT
(GARDENA - 1990) ELEV. 16.704

Experience indicates that this general adjustment will, for the most part, remain sound for the next 10 years. Updating constrained adjustments will be made in 5 years. It is expected that these updating adjustments will be in the nature of a few hundredths of a foot. When a quad is readjusted, new elevation lists will be published and the date of the readjustment will be noted in the bench mark description. Two bench marks with different adjustment dates will not normally agree with each other.

The basic accuracy of the net is reflected by an indicated field probable error of plus or minus 0.012 foot per mile of leveling as determined from over 600 conditions of closure. However, many years experience in vertical control in the greater Los Angeles basin and Antelope Valley indicate that because of varying degrees of subsidence and heaving, the true datum is recovered only by obtaining substantial agreement of a number of bench marks.

The users of this net are invited to assist in its maintenance by notifying this Department of cases of obliteration, apparent mistakes in descriptions or elevations, and proven disturbance of bench marks.

DATUM: U.S. Coast and Geodetic Survey Sea Level Datum
of 1929, through the medium of the Los Angeles
County Engineer Precise Level Net.

2 8 76 5*

ABBREVIATIONS USED IN BENCH MARK LISTINGS

ABUT -----	Abutment	ECR -----	End of Curb Return
ALG -----	Along	EC -----	End of Curve
ANG PT -----	Angle Point	ENT -----	Entrance
B/W -----	Back of Walk	FL -----	Floor
BCR -----	Beginning of Curb Return	FTG -----	Footing
BC -----	Beginning of Curve	FRWY -----	Freeway
BLDG -----	Building	F/W -----	Front of Walk
BM -----	Bench Mark	GAR -----	Garage
BT SPK -----	Boat or Bolt Spike	HDWL -----	Headwall
BR CAP -----	Brass or Bronze Cap	HSE -----	House
C B -----	Catch Basin	HWY -----	Highway
CTR -----	Center	INT -----	Intersection
C/L -----	Center Line	IP -----	Iron Pipe
C/L INT -----	Center Line Intersection	LT -----	Left
C/L PROD -----	Center Line Produced	LACE -----	L.A. City Engineer
CONC -----	Concrete	LACS -----	L.A. Co. Engineer
COR -----	Corner	LAFC -----	L.A. Co. Flood Control
COE -----	Corps of Engineers	L&BN -----	Lead and Bench Nail
CULV -----	Culvert	L&BR -----	Lead and Brad
CYN -----	Canyon	L&N -----	Lead and Nail
CB -----	Curb	L&SPK -----	Lead and Spike
CS MON -----	Co. Eng. Monument	L&T -----	Lead and Tack
CT SPK -----	Cut Spike	MCR -----	Middle of Curb Return
DPW -----	Dept. of Public Works	MKD -----	Marked
DR -----	Drive or Driveway	MC -----	Middle of Curve
E/O -----	East of	MON -----	Monument

23 12 50

ABBREVIATIONS USED IN BENCH MARKS (CON'T)

N/O ----- North of
NR ----- Near
OPP ----- Opposite
PI ----- Point of Intersection
PK&W ----- PK Nail and Washer
P/L ----- Property Line
POST ----- Point of Semi-Tangent
PP ----- Power Pole
PVMT ----- Pavement
PROD ----- Produced
RD ----- Road
RDBM ----- Road Dept. Bench Mark
RDBM TAG ----- Road Dept. Bench Mark Tag
RR ----- Railroad
RT ----- Right
R/W ----- Right of Way
SDMH ----- Storm Drain Manhole
SMH ----- Sewer Manhole
SPK ----- Spike
ST&W ----- Spike Tin and Washer
S/O ----- South of
TP ----- Telephone Pole
USC&GS ----- U.S. Coast and Geodetic Survey
USGS ----- U.S. Geological Survey
WK ----- Walk
W/O ----- West of

D90/L-3

ANGELES

POMONA

QUAD

2-20-91

QUAD

DIMAS

SAN

OTTERBEIN

QUAD

COUNTY
COUNTY

ANGELES
BERNARDINO

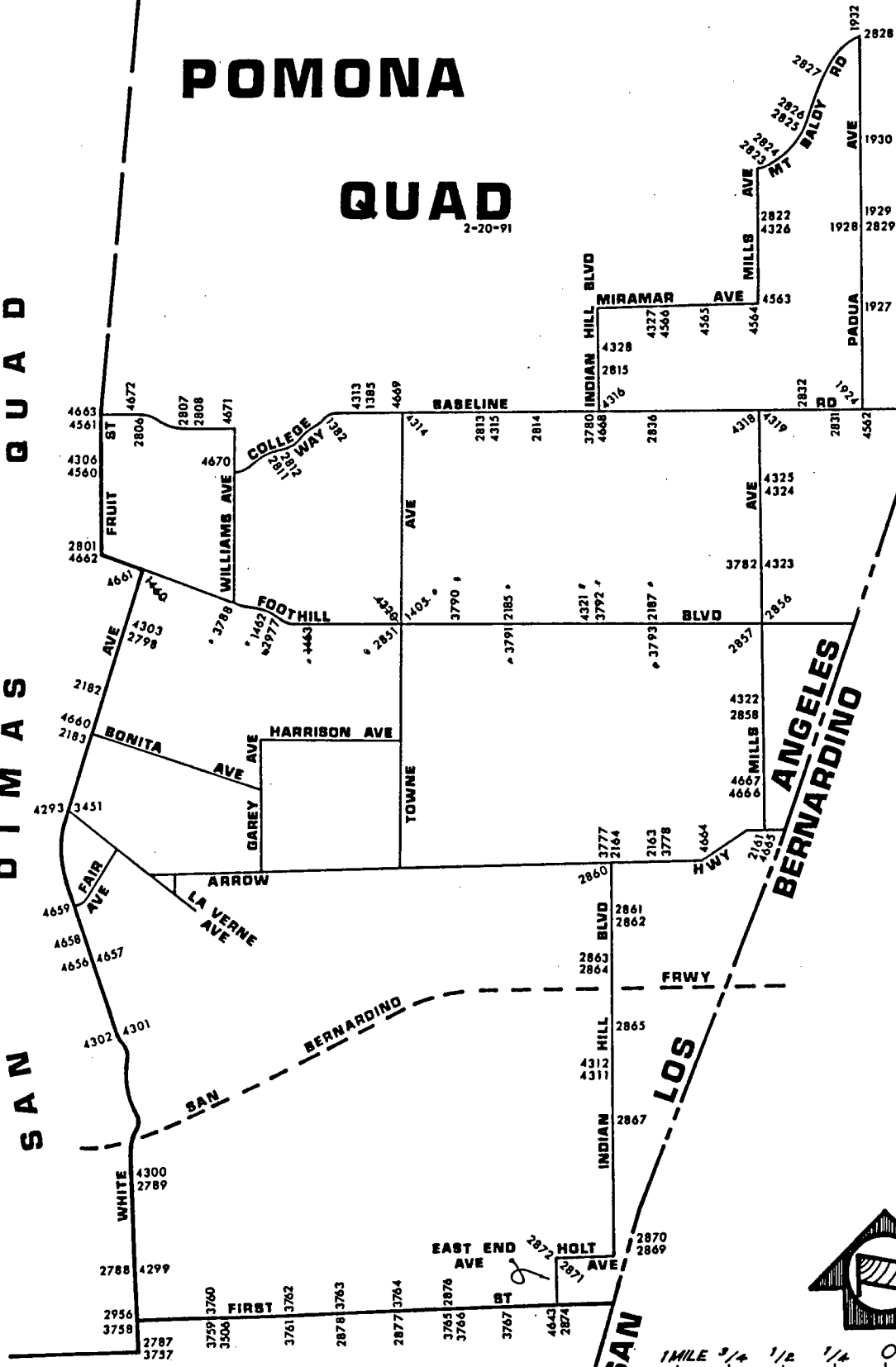

LIGHT SOLID LINES WITHOUT NUMBERS INDICATE PREVIOUS LINES OF BENCH MARKS THAT ARE NOT INCLUDED IN THE 1980 ADJUSTMENT.

QUAD-YEAR	ELEV	DESCRIPTION (INCLUDE QUAD AND YEAR IN DESCRIPTION)	BM NUMBER
POMONA (1990)	1345.923	USC&GS BR CAP 3FT N C/L PROD BASE LINE RD & 40FT DG NW C/L COLLEGE WAY MKD (USC&GS FRENCH)	1382
POMONA (1990)	1337.905	L&T E CB 12FT N BCR @ NE COR BASE LINE RD & LIVE OAK DR 15FT E & 49FT N C/L INT	DG 1385
POMONA (1990)	1196.153	L&T 15FT W BCR @ SE COR TOWNE AVE FOOTHILL BLVD 58FT E & 40FT S C/L INT	DG 1405
BASELINE (1990)	1150.446	CS MON SE COR TOWNE CENTER DR & FOOTHILL BLVD 15FT E & 51FT S/O C/L INT MKD (13-9 1952)	DG 1460
POMONA (1990)	1164.890	L&T IN S CB 1FT W BCR @ SE COR GAREY AVE & FOOTHILL BLVD 2FT W C B 70FT E & 38FT S C/L INT	DG 1462
POMONA (1990)	1171.912	L & BN IN CB 38FT S C/L FOOTHILL BLVD & 344FT W C/L SUMMER AVE (MKD SD 507)	DG 1463
POMONA (1990)	1516.378	CS BR CAP MON IN WELL 3FT SE C/L INT PADUA AVE & BASELINE RD MKD (LA VERNE M 10 RE 2177) 3FT SE FOUND CO ENG SEC COR IN WELL	DG 1924
POMONA (1990)	1604.770	L&T IN TOP OF WINGWALL @ ENT TO DR 35FT E & 5FT S OF C/L INT PADUA AVE & MIRAMAR AVE MKD (BM)	DG 1927
POMONA (1990)	1686.247	RDBM TAG IN BRICK BASE OF FENCE 2FT W OF COR 30FT S & 32FT W C/L INT PADUA AVE & POMELO DR	DG 1928
POMONA (1990)	1686.888	CS BR CAP MON IN WELL @ C/L INT PADUA AVE & POMELO DR USE NE EDGE	DG 1929
POMONA (1990)	1759.933	CS BR CAP MON IN WELL @ C/L INT PADUA AVE 0.5MI N POMELO DR NR DRWY TO HSE NO 4064 MKD (1/4 SEC T1N R8W S26-27) 25FT SE PP NO 26909Y USE E EDGE	DG 1930
POMONA (1990)	1808.081	RDBM TAG 18IN S OF N EDGE OF CONC DR 1FT E OF BLOCK PILLAR @ ENT TO L A CO FIRE STA NO 62 264FT N & 28FT W C/L INT PADUA AVE & MT BALDY RD	DG 1932
POMONA (1990)	1153.793	L&BN S CB ARROW HWY 1FT E BCR @ SE COR MILLS AVE 30FT S & 77FT E C/L INT	DG 2161
POMONA (1990)	1108.636	L&PK W CB COLLEGE AVE 52FT N BCR @ NW COR ARROW HWY 26FT W & 90FT N C/L INT	DG 2163
POMONA (1990)	1110.269	RDBM TAG S CB 40FT S C/L ARROW HWY & 210FT E C/L INDIAN HILL BLVD	DG 2164

QUAD-YEAR	ELEV	DESCRIPTION (INCLUDE QUAD AND YEAR IN DESCRIPTION)	BM NUMBER
BASELINE (1990)	1081.874	CS MON IN WELL 2FT N OF N CB 7TH ST 17FT W BCR @ NW COR WHITE AVE 18FT N & 43FT W/O C/L INT MKD (BM 13-8 1952)	DG 2182
BASELINE (1990)	1063.800	L&BN W CB WHITE AVE 7FT S BCR @ SW COR BONITA AVE 25FT W & 71FT S C/L INT	DG 2183
POMONA (1990)	1231.191	BT SPK E CB @ NE COR MOUNTAIN AVE & FOOTHILL BLVD IN N WALL C B 30FT E & 65FT N C/L INT MKD (SD 515)	DG 2185
POMONA (1990)	1282.386	L&PK @ NW COR FOOTHILL BLVD & COLLEGE AVE 10FT W/O BCR 55FT W & 57FT N C/L INT MKD (33)	DG 2187
BASELINE (1990)	846.107	L&BN E CB WHITE AVE 1FT N BCR @ NE COR 2ND ST 61FT N & 42FT E C/L INT	DG 2787
POMONA (1990)	858.246	CS MON IN WELL 7IN DN IN GUTTER @ SW COR HOLT AVE & WHITE AVE 36FT S & 55FT W C/L INT MKD (BM 13-1 1952)	DG 2788
BASELINE (1990)	884.742	CS MON 8IN DN @ SE COR WHITE AVE & ORANGE GROVE AVE 46FT E C/L WHITE AVE & 2FT S OF S CB LINE ORANGE GROVE AVE MKD (BM 13-2B 1959 RESET)	DG 2789
BASELINE (1990)	1102.400	L&BN E CB WHITE AVE 1FT S BCR @ SE COR KENDALL ST 50FT S & 40FT E C/L INT	DG 2798
BASELINE (1990)	1139.766	BT SPK 61FT N BCR 163FT N & 40FT W C/L INT FOOTHILL BLVD & FRUIT ST MKD (BM 13-10B)	DG 2801
POMONA (1990)	1194.021	CS TAG S CB BASELINE RD 23FT W BCR @ SW COR JAPONICA AVE 79FT W & 40FT S C/L INT	DG 2806
POMONA (1990)	1220.242	L&BN N CB BASELINE RD 1FT W BCR @ NW COR ST MARK AVE 52FT W & 34FT N C/L INT	DG 2807
POMONA (1990)	1224.383	L&BN N CB BASELINE RD @ NE COR ST MARK AVE 52FT E & 34FT N C/L INT	DG 2808
POMONA (1990)	1308.644	RAMSET S CB COLLEGE WAY 1FT W BCR @ SW COR TENANGO RD 62FT W & 18FT S C/L INT	DG 2811
POMONA (1990)	1311.957	RDBM TAG S CB COLLEGE WAY 2FT E BCR @ SE COR TENANGO RD 60FT E & 18FT S C/L INT	DG 2812
POMONA (1990)	1346.482	L & T W CB MOUNTAIN AVE 0.5FT S BCR @ SW COR BASELINE RD & MOUNTAIN AVE 70FT S & 28FT W C/L INT	DG 2813
POMONA (1990)	1369.246	RDBM TAG S CB BASELINE RD 40FT S & 184FT E C/L INT VILLA MARIA RD	DG 2814

QUAD-YEAR	ELEV	DESCRIPTION (INCLUDE QUAD AND YEAR IN DESCRIPTION)	BM NUMBER
POMONA (1990)	1419.561	L & T S CB TO DRWY OF HSE NO 2258 INDIAN HILL BLVD 63FT E C/L 248FT S INT SAN LUIS PL	DG 2815
POMONA (1990)	1621.161	2IN IP C/L MILLS AVE 52FT N C/L POMELLO DR 3IN DN (USE NE EDGE)	DG 2822
POMONA (1990)	1660.778	L & BN SW LEG CONC BASE TO TOWER NO 228 D6 400FT E & 81FT N C/L INT MILLS AVE & MT BALDY RD	DG 2823
POMONA (1990)	1660.764	L & BN SE LEG CONC BASE TO TOWER NO 228 D6 435FT E & 81FT N C/L INT MILLS AVE & MT BALDY RD	DG 2824
POMONA (1990)	1687.589	L&BN SE CONC BASE TO TOWER 228 D 5 @ NW COR MT BALDY RD & VIA PADOVA 82FT N & 56FT W C/L INT	DG 2825
POMONA (1990)	1690.532	L&BN N END ROCK WALL 52FT N & 25FT W MT BALDY RD & VIA PADOVA	DG 2826
POMONA (1990)	1733.350	L&T BOT STEP CONC WK TO POTTERY SHOP NO 4111 APPROX 0.25MI E VIA PADOVA & 78FT N/O C/L MT BALDY RD MKD (BM)	DG 2827
POMONA (1990)	1806.827	L&T ROCK WL @ NE COR MT BALDY RD & PADUA AVE 77 FT N & 30FT E C/L INT	DG 2828
POMONA (1990)	1685.918	RDBM TAG E CB PADUA AVE 3FT S BCR @ SE COR PAM- ELLO DR 58FT S & 32FT E C/L INT	DG 2829
POMONA (1990)	1512.601	L&T CONC STEP TO ROCK PUMP HSE NO 1900 283FT W & 32FT S C/L INT PADUA AVE & BASELINE RD MKD (BM)	DG 2831
POMONA (1990)	1487.555	RAMSET E CB CLAREMONT HEIGHTS DR 1FT N BCR @ NE COR BASELINE RD 63FT N & 18FT E C/L INT	DG 2832
POMONA (1990)	1419.191	RDBM TAG S CB BASELINE RD 55FT W & 40FT S/O C/L INT FORBES AVE	DG 2836
POMONA (1990)	1194.407	CS BR CAP MON IN WELL @ SE COR FOOTHILL BLVD & TOWNE AVE 67FT S & 51FT E C/L INT MKD (RE 5869 1961 RM 5)	DG 2851
POMONA (1990)	1307.544	L&PK N CB 5FT E BCR @ NE COR FOOTHILL BLVD & MILLS AVE 50FT E & 45FT N C/L INT	DG 2856
POMONA (1990)	1304.742	RDBM TAG S CB 1FT W BCR @ SW COR FOOTHILL BLVD & MILLS AVE 45FT S & 55FT W C/L INT	DG 2857
POMONA (1990)	1223.292	L&T W CB MILLS AVE 25FT S BCR @ SW COR 6TH ST 56FT S & 18FT W C/L INT	DG 2858

QUAD-YEAR	ELEV	DESCRIPTION (INCLUDE QUAD AND YEAR IN DESCRIPTION)	BM NUMBER
POMONA (1990)	1107.567	L&T E CB INDIAN HILL BLVD 1FT N BCR @ SE COR ARROW HWY 73FT S & 42FT E C/L INT	DG 2860
POMONA (1990)	1077.173	L&PK W CB INDIAN HILL BLVD 5FT N BCR @ NW COR VISTA DR 58FT N & 35FT W C/L INT	DG 2861
POMONA (1990)	1073.900	RDBM TAG W CB INDIAN HILL BLVD 1FT S BCR @ SW COR VISTA DR 53FT S & 35FT W C/L INT	DG 2862
POMONA (1990)	1045.995	RDBM TAG W CB INDIAN HILL BLVD 1FT N BCR @ NW COR SAN JOSE AVE 55FT N & 40FT W C/L INT	DG 2863
POMONA (1990)	1043.253	RDBM TAG E CB INDIAN HILL BLVD 1FT S BCR @ SE COR SAN JOSE AVE 62FT S & 40FT E C/L INT	DG 2864
POMONA (1990)	1018.468	L&PK S CB AMERICAN AVE 12FT E BCR @ SE COR INDIAN HILL BLVD 80FT E & 17FT S C/L INT	DG 2865
POMONA (1990)	965.269	L&PK W CB INDIAN HILL BLVD 3FT N/O BCR @ NW COR LINCOLN AVE 47FT N & 35FT W C/L INT	DG 2867
POMONA (1990)	921.395	L&PK N CB HOLT AVE 1FT E BCR @ NE COR INDIAN HILL BLVD 72FT E & 39FT N C/L INT	DG 2869
POMONA (1990)	920.625	RDBM TAG N CB HOLT AVE 1FT W BCR @ NW COR INDIAN HILL BLVD 67FT W & 39FT N C/L INT	DG 2870
POMONA (1990)	913.436	L&T S CB HOLT AVE 0.3FT E BCR @ SE COR EAST END AVE 71FT E & 40FT S C/L INT	DG 2871
POMONA (1990)	912.624	L&T W CB EAST END AVE 3FT N BCR @ SW COR HOLT AVE 80FT S & 35FT W C/L INT	DG 2872
BASELINE (1990)	898.694	CS BR CAP MON FL 1FT S CF & 8FT W/O BCR S CB E FIRST ST @ SW COR EAST END AVE 84FT W & 21FT S C/L INT MKD (11-77-A 1959 CE RE 5869)	DG 2874
BASELINE (1990)	884.979	BR PLATE FL N END C B 30FT E C/L RESERVOIR ST 150FT N C/L E FIRST ST (MKD BM11-78A 1962 RE 5869)	DG 2876
BASELINE (1990)	876.783	L & BR E CB SAN ANTONIO AVE @ SE COR E FIRST ST 64FT S & 35FT E C/L INT	DG 2877
BASELINE (1990)	875.582	LACS BM MON FL @ SW ABUT OF BRIDGE OVER TOWNE AVE & 51FT W C/L 27FT S C/L FIRST ST MKD (CE BM 11-79A 1962 RE 5869)	DG 2878
BASELINE (1990)	850.663	CS BM MON FL IN HDWL 27FT S C/L FIRST ST & 84FT W WHITE AVE MKD (BM 11-83-A 1962 RE 5869)	DG 2956

QUAD-YEAR	ELEV	DESCRIPTION (INCLUDE QUAD AND YEAR IN DESCRIPTION)	BM NUMBER
POMONA (1990)	1164.138	L&N W CB 48FT S BCR @ SW COR FOOTHILL BLVD & GAREY AVE 111FT S & 42FT W C/L INT MKD (SD 504)	DG 2977
BASELINE (1990)	1036.716	RDBM TAG 1FT N'LY BCR 60FT S'LY & 40FT W'LY C/L INT ARROW HWY & WHITE AVE	DG 3451
BASELINE (1990)	858.728	USC&GS MON FL @ W END C B 40FT E & 20FT N C/L INT FIRST ST & GORDON ST (MKD Q36 861 RESET 67)	DG 3506
BASELINE (1990)	845.861	RDBM TAG IN W CB 2FT S BCR 65FT S & 32FT W C/L INT 2ND ST & WHITE AVE	DG 3757
BASELINE (1990)	851.300	RDBM TAG IN S CB 30FT E BRIDGE ABUT 21FT S & 77FT E C/L INT FIRST ST & WHITE AVE	DG 3758
BASELINE (1990)	859.078	RDBM TAG IN N CB 20FT N & 5FT E C/L INT 1ST ST & S GORDON ST	DG 3759
BASELINE (1990)	857.190	RDBM TAG IN E CB 35FT S & 24FT E C/L INT 1ST ST & S GORDON ST	DG 3760
BASELINE (1990)	867.773	RDBM TAG N CB 5FT W/O BCR 20FT N & 60FT W C/L INT FIRST ST & PALOMARES ST	DG 3761
BASELINE (1990)	868.521	RDBM TAG IN S CB 1FT E BCR 20FT S & .59FT E C/L INT 1ST ST & PALOMARES ST	DG 3762
BASELINE (1990)	875.112	L & PK IN E END WINGWALL OF BRIDGE OVER TOWNE AV 26FT S & 79FT E C/L INT 1ST ST & TOWNE AVE	DG 3763
BASELINE (1990)	877.767	RDBM TAG IN N CB 6FT W/O END 20FT N & 72FT W C/L INT 1ST ST & SAN ANTONIO AVE	DG 3764
BASELINE (1990)	883.608	RDBM TAG IN N CB 20FT N & 92FT W C/L INT 1ST ST & RESERVOIR ST	DG 3765
BASELINE (1990)	882.874	RDBM TAG IN S CB 2FT E BCR 20FT S & 59FT E C/L INT 1ST ST & RESERVOIR ST	DG 3766
BASELINE (1990)	888.842	RDBM TAG IN CB 20FT S C/L 1ST ST @ E P/L WATER RESERVOIR 286FT E INT ELECTRA ST	DG 3767
POMONA (1990)	1110.829	RDBM TAG 2FT E BCR 40FT N & 65FT E C/L INT ARROW HWY & INDIAN HILL BLVD 1FT W/O W END C B	DG 3777
POMONA (1990)	1107.614	RDBM TAG 6FT N BCR 47FT N & 25FT E C/L INT ARROW HWY & COLLEGE AVE NR C B	DG 3778
POMONA (1990)	1394.452	USC&GS MON FL IN CB 3FT E BCR 40FT N 75FT W C/L INT BASE LINE RD & INDIAN HILL BLVD MKD (D 36 RESET 1967)	DG 3780

QUAD-YEAR	ELEV	DESCRIPTION (INCLUDE QUAD AND YEAR IN DESCRIPTION)	BM NUMBER
POMONA (1990)	1354.459	L & PK 1FT N BCR 60FT N & 35FT W C/L INT MILLS AVE & BLAISDELL DR	DG 3782
POMONA (1990)	1161.573	LAFC BR CAP MON FL 22FT N/O BCR 94FT N & 20FT E C/L INT FOOTHILL BLVD & WILLIAMS AVE MKD (105-01905)	DG 3788
POMONA (1990)	1214.796	RDBM TAG IN N CB FOOTHILL BLVD 38FT N C/L & 550FT E C/L REGIS ST 75FT E/O BLDG NO. 973	DG 3790
POMONA (1990)	1230.557	RDBM TAG 35FT E BCR 38FT S & 103FT E C/L INT FOOTHILL BLVD & MOUNTAIN AVE @ ENT TO C B	DG 3791
POMONA (1990)	1257.318	RDBM TAG 5FT N BCR 105FT N & 35FT E C/L INT FOOTHILL BLVD & INDIAN HILL BLVD	DG 3792
POMONA (1990)	1280.544	RDBM TAG 3FT W BCR 55FT S & 46FT W C/L INT FOOTHILL BLVD & COLLEGE AVE	DG 3793
BASELINE (1990)	1038.248	L & T CTR CB RET @ NW COR WHITE AVE & ARROW HWY 55FT N/O & 70FT W/O C/L INT	DG 4293
BASELINE (1990)	859.556	RAMSET 17FT S/O BCR @ SE COR WHITE AVE & HOLT AVE 34FT E & 87FT S/O C/L INT	DG 4299
BASELINE (1990)	887.175	L&PK NAIL CTR CB RET @ NE COR WHITE AVE & ORANGE GROVE AVE 46FT N & 54FT E/O C/L INT	DG 4300
BASELINE (1990)	933.990	PK IN CONC CB 1FT N/O BCR @ SE COR WHITE AVE & MC KINLEY AVE 71FT S & 55FT E/O C/L INT	DG 4301
BASELINE (1990)	935.652	LAFC BR DISC @ W END CONC HDWL OF FC CHANNEL @ NW COR MC KINLEY AVE & WHITE AVE 37FT N & 114FT W/O C/L INT MKD (BM 105-00005)	DG 4302
BASELINE (1990)	1102.588	L&T W CB WHITE AVE 40FT W/O C/L & 25FT S/O C/L PROD KENDELL ST	DG 4303
BASELINE (1990)	1160.967	RDBM TAG 2FT S/O BCR @ SW COR FRUIT ST & BOWDOIN ST 54FT S & 42FT W/O C/L INT	DG 4306
POMONA (1990)	992.455	RDBM TAG E CB 1FT S/O BCR 61FT S & 35FT E C/L INT SAN BERNARDINO AVE & INDIAN HILL BLVD	DG 4311
POMONA (1990)	995.127	RDBM TAG E CB 1FT N BCR 60FT N & 35FT E C/L INT SAN BERNARDINO AVE & INDIAN HILL BLVD	DG 4312
POMONA (1990)	1338.970	PK NAIL IN CONC CB 10FT N/O BCR @ NW COR LIVE OAK DR & BASELINE RD 36FT N & 15FT W C/L INT	DG 4313
POMONA (1990)	1305.854	RDBM TAG IN NW COR WEIR BOX 13FT E & 193FT N C/L INT TOWNE AVE & BASELINE RD	DG 4314

QUAD-YEAR	ELEV	DESCRIPTION (INCLUDE QUAD AND YEAR IN DESCRIPTION)	BM NUMBER
POMONA (1990)	1347.096	L & BR 1FT S BCR @ SE COR MOUNTAIN AVE & BASELINE RD 75FT S & 28FT E C/L INT	DG 4315
POMONA (1980)	1394.938	LAFC MON IN WELL 2FT N BASELINE RD & 4FT E INDIAN HILL BLVD MKD (LACO FC DIST) USE N EDGE	CG 4316
POMONA (1990)	1458.322	RDBM TAG IN NE COR CONC DRAIN 50FT S C/L BASELINE RD & 317FT W C/L MILLS AVE	DG 4318
POMONA (1990)	1467.967	LAFC MON IN WELL 2FT S C/L BASELINE RD & 2FT W C/L MILLS AVE MKD (LAFC DIST)	DG 4319
POMONA (1990)	1195.935	LACS CONT SYS MON FL @ NW COR FOOTHILL BLVD & TOWNE AVE 1FT BK OF WALK 60FT N & 60FT W C/L INT MKD (LA VERNE RM 3 1961)	DG 4320
POMONA (1990)	1256.777	NAIL IN CONC CB 1FT S/O BCR @ NW COR INDIAN HILL BLVD & FOOTHILL BLVD 40FT W & 83FT N C/L INT	DG 4321
POMONA (1990)	1225.957	LACS BM MON 3FT N/O BCR 54FT N & 27FT W C/L INT 6TH ST & MILLS AVE MKD (BENCH MARK NO 700.43	DG 4322
POMONA (1990)	1352.818	RCE TAG NO 9009 S CB BLAISDELL DR 5FT W/O BCR SE COR MILLS AVE 62FT E & 19FT S C/L INT	DG 4323
POMONA (1990)	1404.490	RCE TAG NO 7344 S CB BLACK HILLS DR 1FT E/O BCR @ SE COR MILLS AVE 61FT E & 18FT S C/L INT	DG 4324
POMONA (1990)	1405.349	RCE TAG NO 7344 E CB MILLS AVE 5FT N/O BCR @ NE COR BLACK HILLS DR 50FT N & 33FT E C/L INT	DG 4325
POMONA (1990)	1620.840	RDBM TAG NW SIDE CONC BASE TO PP NO 1822460E 25FT S & 22FT E C/L INT POMELO DR & MILLS AVE	DG 4326
POMONA (1990)	1486.098	RDBM TAG W CB FORBES AVE 15FT W C/L @ ENT WK TO SCHOOL & 83FT S INT MIRAMAR AVE	DG 4327
POMONA (1990)	1447.114	RDBM TAG IN CB 5FT S/O BCR @ SW COR 76FT S & 40FT W C/L INT MT CARMEL DR & INDIAN HILL BLVD	DG 4328
BASELINE (1990)	1163.319	RDBM TAG 1FT N/O BCR 42FT E/O C/L FRUIT ST & 59FT N/O C/L BOWDOIN ST	DG 4560
BASELINE (1990)	1172.138	RDBM TAG IN CONC CB 1FT W/O BCR 42FT S/O C/L BASELINE RD & 78FT W/O C/L FRUIT ST	DG 4561
POMONA (1990)	1515.522	L&BR IN CONC CB 1FT W/O BCR 40FT N/O C/L BASELINE RD & 78FT W/O C/L PADUA AVE	DG 4562
POMONA (1990)	1546.298	L&PK 3FT S/O BCR 32FT E/O C/L MILLS AVE & 58FT S/O C/L MIRAMAR AVE	DG 4563

QUAD-YEAR	ELEV	DESCRIPTION (INCLUDE QUAD AND YEAR IN DESCRIPTION)	BM NUMBER
POMONA (1990)	1548.357	RDBM TAG 1FT W/O BCR 20FT S/O C/L MIRAMAR AVE & 63FT W/O C/L MILLS AVE	DG 4564
POMONA (1990)	1520.920	RDBM TAG 1FT W/O BCR 20FT S/O C/L MIRAMAR AVE & 45FT W/O C/L BONNIE BRAE AVE	DG 4565
POMONA (1990)	1487.686	LACS TAG IN CB ON C/L PROD MIRAMAR AVE & 23FT W/O C/L FORBES AVE	DG 4566
BASELINE (1990)	897.663	DPW BM TAG E CB 60FT S & 40FT E/O C/L INT 1ST ST & EAST END AVE (5FT S/O BCR @ SE COR)	DG 4643
BASELINE (1990)	962.610	L&PK IN CONC HDWL @ SE COR BRIDGE #B 2825 OVER THOMPSON CREEK 51FT E/O C/L WHITE AVE & 0.3MI N/O MC KINLEY AVE	DG 4656
BASELINE (1990)	962.879	COE BM MON FL @ N END C B 46FT E/O C/L WHITE AVE 53FT N/O N END BRIDGE #B 2825 OVER THOMPSON CREEK 68FT S/O C/L GATE #5 MKD (TSJ 120 1980)	DG 4657
BASELINE (1990)	984.912	DPW BM TAG IN CONC HDWL @ NW COR UNDERPASS TO GATE D 56FT W/O C/L WHITE AVE 0.4MI N/O MC KINLEY AVE	DG 4658
BASELINE (1990)	1001.182	DPW BM TAG IN E CB WHITE AVE 10FT N/O BCR IN ISLAND @ GATE #14 TO LA CO FAIR GROUNDS 0.4MI S/O ARROW HWY & 47FT E/O C/L WHITE AVE	DG 4659
BASELINE (1990)	1065.032	DPW BM TAG E CB WHITE AVE 1FT S/O BCR @ NE COR BONITA AVE & WHITE AVE 25FT E & 39FT N/O C/L INT	DG 4660
BASELINE (1990)	1153.795	DPW BM TAG 30FT E/O BCR W END C B @ NE COR FOOTHILL BLVD & TOWNE CENTER DR 42FT N & 80FT E/O C/L INT	DG 4661
BASELINE (1990)	1140.208	DPW BM TAG 5FT E/O BCR W END C B @ NE COR FOOTHILL BLVD & FRUIT ST 42FT N & 72FT E/O C/L INT	DG 4662
BASELINE (1990)	1176.630	SPK&W IN N CB 47FT E/O C/L PROD FRUIT ST (SOUTH) 40FT N/O C/L INT BASELINE RD & FRUIT ST	DG 4663
POMONA (1990)	1120.423	DPW BM TAG IN S CB @ BCR SE COR ARROW HWY & VILLANOVA DR 32FT S & 39FT E/O C/L INT	DG 4664
POMONA (1990)	1155.122	DPW BM TAG W CB 1FT N/O BCR @ NW COR CLAREMONT BLVD & ARROW HWY 42FT W & 62FT N/O C/L INT	DG 4665
POMONA (1990)	1177.788	DPW BM TAG E CB 5FT N/O BCR @ NE COR MILLS AVE & FIRST ST 58FT N & 18FT E/O C/L INT	DG 4666

QUAD-YEAR	ELEV	DESCRIPTION (INCLUDE QUAD AND YEAR IN DESCRIPTION)	BM NUMBER
POMONA (1990)	1178.121	DPW BM TAG IN W CB 24FT N/O BCR @ NW COR MILLS AVE & FIRST ST 75FT N & 18FT W/O C/L INT	DG 4667
POMONA (1990)	1397.730	DPW BM TAG IN E CB 26FT N/O BCR 40FT E & 98FT N/O C/L INT BASELINE RD & INDIAN HILL BL	DG 4668
POMONA (1990)	1300.378	DPW BM TAG @ NW COR OF 2X2 CONC GAS VENT PAD @ SE COR BASELINE RD & TOWNE AVE 41FT S & 72FT E/O C/L INT	DG 4669
POMONA (1990)	1257.911	DPW BM TAG @ BCR OF SW COR BOWDOIN ST & WILLIAMS AVE 40FT W & 20FT S/O C/L INT	DG 4670
POMONA (1990)	1272.225	DPW BM TAG 10FT W/O BCR @ SW COR BASELINE RD & WILLIAMS AVE 40FT S & 68FT W/O C/L INT	DG 4671
POMONA (1990)	1192.255	DPW BM TAG 28FT E/O BCR @ NE COR BASELINE RD & RODEO LN 40FT N & 85FT E/O C/L INT	DG 4672